



MADREVITI

SCREW GROMMETS

MADREVITI STANDARD

Standard screw grommets

MADREVITI AD ALTA COPPIA

Heavy duty screw grommets

MADREVITI REGOLABILI

Adjustable screw grommets

MADREVITI A TENUTA STAGNA

Watertight screw grommets

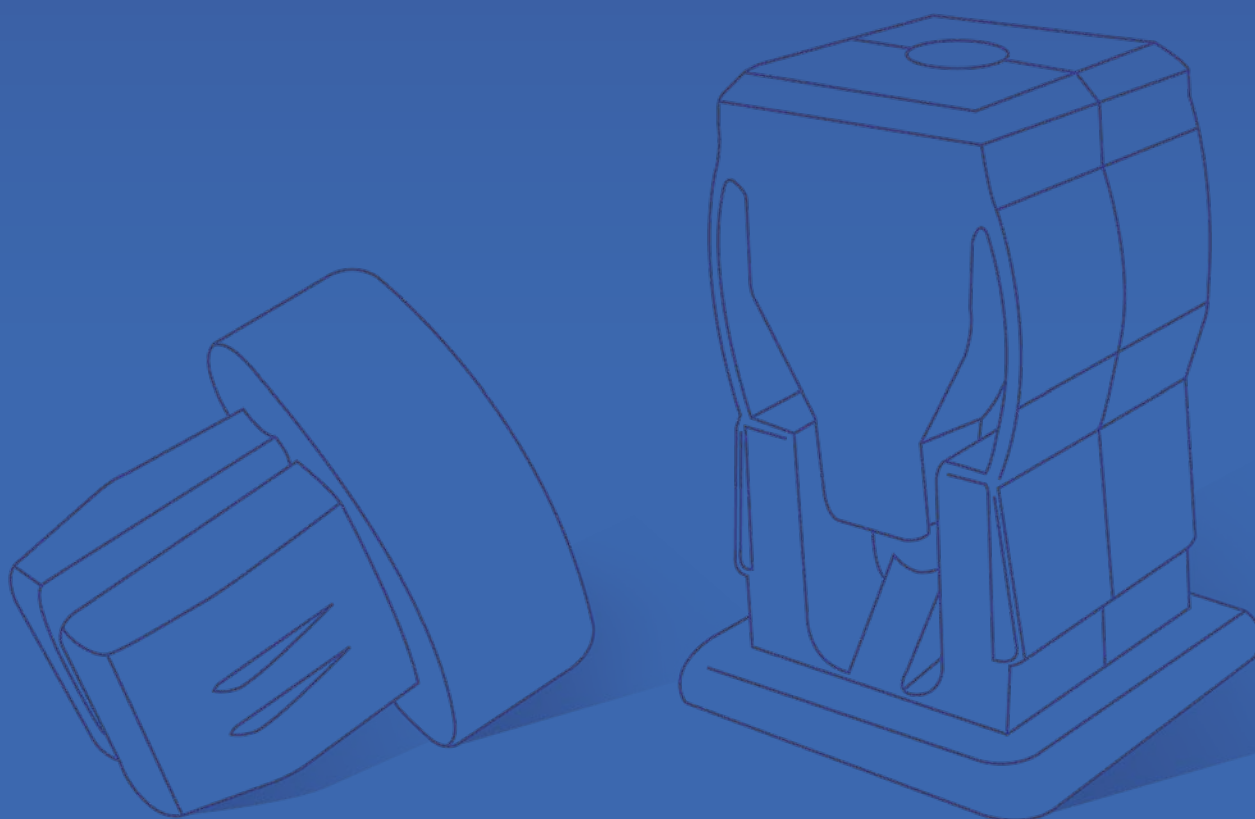

MATERIALE | MATERIAL: Nylon 66 | PA 66

COLORI STANDARD | STANDARD COLOURS: Naturale - Nero - Rosso - Giallo - Azzurro | Natural - Black - Red - Yellow - Light blue



P/N	DIMENSIONI Sizes			PANNELLO Panel		VITE Screw ISO N°	TIPO Type
	A	L	H	FORO Hole	SPESSORE Thickness		
02416.94.10	5,5	5,7	1,0	4,5 x 4,5	0,5 ÷ 1,5	6	
00108.21.10	Ø 8,5	5,5	1,2	4,5 x 4,5	0,8 ÷ 2,5	6	
01140.94.10	9,0	5,8	1,2	5,5 x 5,5	0,5 ÷ 2,0	4 ÷ 6	
04454.02.10	9,5	7,0	1,2	6,3 x 6,3	0,5 ÷ 3,0	6	
00534.91.10	10,0	5,0	1,0	7,0 x 7,0	0,5 ÷ 1,5	10	
00088.15.10	9,5	8,0	1,0	7,0 x 7,0	0,5 ÷ 2,5	8	
00037.65.10	Ø 9,5	8,0	1,0	7,0 x 7,0	0,5 ÷ 3,0	8	
00259.95.10U	Ø 13,0	8,0	1,0	7,0 x 7,0	0,5 ÷ 3,5	8 ÷ 10	
04549.03.14	9,5	8,0	1,2	7,0 x 7,0	0,5 ÷ 4,0	8	
01710.94.10U	Ø 10,0	12,0	1,0	7,0 x 7,0	0,7 ÷ 7,0	6 ÷ 8	
00487.06.18	11,0	7,5	1,5	8,0 x 8,0	0,7 ÷ 2,0	10	
09370.94.11	12,5	7,5	1,5	10,0 x 10,0	0,7 ÷ 2,0	10	

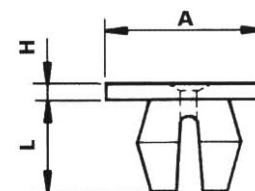

P/N	DIMENSIONI Sizes				PANNELLO Panel		VITE Screw ISO N°	TIPO Type
	A	Ø D	L	H	FORO Hole	SPESSORE Thickness		
01092.21.10	Ø 8,5	2,5	5,5	5,0	4,5 x 4,5	0,8 ÷ 2,5	6	
00049.91.10	Ø 7,0	3,7	7,0	3,2	6,5 x 6,5	0,5 ÷ 3,0	6 ÷ 8	
00014.91.10	Ø 12,5	8,5	8,0	4,5	7,0 x 7,0	0,5 ÷ 4,0	8 ÷ 10	
00016.91.10	Ø 12,5	8,5	8,0	7,0	7,0 x 7,0	0,5 ÷ 4,0	8 ÷ 10	
00015.91.10	Ø 12,5	8,5	8,0	10,5	7,0 x 7,0	0,5 ÷ 4,0	8 ÷ 10	
00051.91.10	Ø 12,5	8,5	8,0	16,0	7,0 x 7,0	0,5 ÷ 4,0	8 ÷ 10	
00052.91.10	Ø 12,5	8,5	8,0	20,0	7,0 x 7,0	0,5 ÷ 4,0	8 ÷ 10	

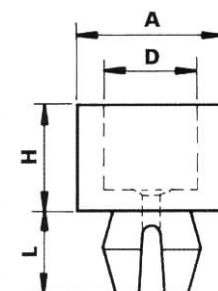

MATERIALE | MATERIAL: Nylon 66 | PA 66

COLORI STANDARD | STANDARD COLOURS: Naturale - Nero - Rosso - Azzurro | Natural - Black - Red - Light blue



P/N	DIMENSIONI Sizes			PANNELLO Panel		VITE Screw ISO N°	TIPO Type
	A	L	H	FORO Hole	SPESSORE Thickness		
00636.65.10	9,0	9,0	1,0	7,0 x 7,0	0,6 ÷ 1,5	6	
00040.44.10	9,5	10,5	1,0	7,0 x 7,0	0,5 ÷ 1,6	8	
02524.94.10	11,0	11,5	0,8	8,0 x 8,0	0,7 ÷ 2,0	8 ÷ 10,0	
00079.94.10U	12,5	18,0	1,2	9,5 x 9,5	0,5 ÷ 2,0	8 ÷ 10,0	
04710.94.10	14,0 x 16,0	8,0	2,0	12,0 x 8,0	0,7 ÷ 2,0	10 ÷ 12,0	
01765.94.10	9,0	12,5	1,0	7,0 x 7,0	0,7 ÷ 1,5	6	
04796.94.11	11,0	14,8	1,2	8,0 x 8,0	0,7 ÷ 2,0	8	
01757.02.102	12,0	15,8	1,2	9,0 x 9,0	0,7 ÷ 1,5	8	
01429.02.14	14,0	18,5	1,5	10,0 x 10,0	0,7 ÷ 2,0	10	
01376.65.16	15,0	19,5	1,5	11,0 x 11,0	0,7 ÷ 2,0	12	

MATERIALE | MATERIAL: Nylon 66 | PA 66

COLORI STANDARD | STANDARD COLOURS: Naturale - Nero - Giallo | Natural - Black - Yellow



MADREVITI A FONDO CHIUSO | Closed edge grommets

P/N	DIMENSIONI Sizes				PANNELLO Panel		VITE Screw ISO N°	TIPO Type
	A	D	L	H	FORO Hole	SPESSORE Thickness		
01443.44.10	15,5	9,0	8,5	1,2	12,0 x 7,0	0,8 ÷ 2,0	8	
01476.94.11	18,0	10,0	8,5	1,5	15,0 x 7,0	0,8 ÷ 1,2	8	
04180.15.10	18,0	11,0	10,5	1,5	15,0 x 7,0	0,8	6	

MATERIALE | MATERIAL: Nylon 66 | PA 66

COLORI STANDARD | STANDARD COLOURS: Naturale | Natural



P/N	DIMENSIONI Sizes			PANNELLO Panel		VITE Screw ISO N°	TIPO Type
	A	L	H	FORO Hole	SPESSORE Thickness		

00054.91.10	Ø 11,5	10,5	1,3	7,0 x 7,0	0,5 ÷ 2,0	8	
-------------	--------	------	-----	-----------	-----------	---	--

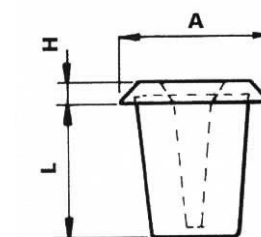

VITI AUTOFILETTANTI

Per una rapida identificazione del tipo di vite autofilettante da impiegare, riportiamo qui sotto una tabella dimensionale di tali viti.

SELF-THREADING SCREWS

For fast identification of the self-threading screw to use, see below the cross reference of ISO standards to external diameter.

NUMERO STANDARD ISO Standard ISO	2	4	6	7	8	10	12	14
DIAMETRO ESTERNO EXTERNAL DIAMETER	2,2	2,9	3,5	3,9	4,2	4,8	5,4	6,4

